

Sealgauge® Flush Diaphragm Sanitary Pressure Gauges

Stainless Steel Case, Stainless Steel Wetted Parts

Type 432.55 - Dry Case

Type 433.55 - Liquid-Filled Case

WIKA Data Sheet 43X.55

Applications

- Suitable for food, biological, pharmaceutical and other industries requiring sanitary process connections
- Quick release connection allows for direct, fast installation and removal in sanitary piping systems.
- Stainless steel diaphragm mechanically linked to the movement - allows a dry measuring system with no pressure transmitting fluid

Special features

- Stainless steel wetted parts and case
- Built to withstand corrosive, highly viscous and crystallizing medium
- No pressure transmitting fluid

Description

Sizes (all sizes not stocked)

4" and 6" (100 and 160 mm)

Accuracy class

± 1.5% of span

Ranges

Vacuum / compound to 30" HG / 0 / 130

Pressure from 10 psi to 145 psi

Working range

Steady: full scale value

Fluctuating: 0.9 x full scale value

Overpressure safety

1.5 X full scale, minimum

40 X full scale, maximum (range dependent)

Operating temperature

Ambient: -4°F to +140°F (-40°C to +60°C)

Media: max. 302°F (+150°C)

Temperature error

Additional error when temperature changes from reference temperature of 68°F (20°C) ±0.4% for every 18°F (10°C) rising or falling. Percentage of span.

**Process connection**

2" Tri-Clamp® connection

Material: 316L stainless steel

(17-7 PH stainless steel for >100 psi)

Diaphragm element

Material: 316L stainless steel

(17-7 PH stainless steel for >100 psi)

Movement

Material: stainless steel

Dial

White aluminum with black lettering

Pointer

Black aluminum

Case

304 stainless steel with blow-out disk and

stainless steel bayonet ring

Lower mount (LM)

Weather protection

Weather resistant (NEMA 4X / IP 54) - dry case

Weather tight (NEMA 4X / IP 65) - liquid-filled case

Standard scalespsi or inches of H₂O**Window gasket**

Buna-N

Window

Laminated safety glass

Order Options (min. order may apply)

- Higher overpressure protection
- Instrument glass window
- Acrylic window
- Process connection styles and sizes
- Connector location at 3, 9, or 12 o'clock
- DIN standards
- Custom dial layouts
- Additional pressure scales available
- Alarm contact switches magnetic and inductive
- Wetted parts and external metallic components electropolished

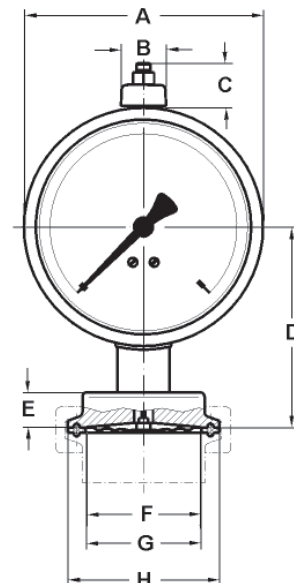
**Tri-Clamp® Connection****Dimensions:**

TYPE	WEIGHT	G	KEY	A	B	C	D	E	F	H
43X.55 4"	1.4 lbs.	2 in.	mm	100	19	19	85	15	48	64
			in	4	0.75	0.75	3.35	0.59	1.89	2.52
	1.9 lbs.	2.5 in.	mm	100	19	19	85	15	48	77.5
			in	4	0.75	0.75	3.35	0.59	1.89	3.05
	2.6 lbs.	3 in.	mm	100	19	19	85	15	48	91
			in	4	0.75	0.75	3.35	0.59	1.89	3.59
43X.55 6"	2.3 lbs.	2 in.	mm	160	19	19	115	15	48	64
			in	6	0.75	0.75	4.53	0.59	1.89	2.52
	2.8 lbs.	2.5 in.	mm	160	19	19	115	15	48	77.5
			in	6	0.75	0.75	4.53	0.59	1.89	3.05
	3.5 lbs.	3 in.	mm	160	19	19	115	15	48	91
			in	6	0.75	0.75	4.53	0.59	1.89	3.59

Ordering information

Pressure gauge model / Nominal size / Scale range / Size of connection / Optional extras required
Specifications and dimensions given in this leaflet represent the state of engineering at the time of printing.
Modifications may take place and materials specified may be replaced by others without prior notice.

**WIKI Instrument Corporation**

1000 Wiegand Boulevard
Lawrenceville, GA 30045
Tel (770) 513-8200 Toll-free 1-888-WIKI-USA
Fax (770) 338-5118
E-Mail info@wika.com
www.wika.com